



Lindfield Gardens | London | NW3

£795 Per Week |



ADN
RESIDENTIAL

A beautifully refurbished two-bedroom apartment set on the first floor of an attractive period property in the heart of Hampstead, NW3.

Finished to an exceptional standard throughout, this contemporary home features a bright open-plan kitchen and reception area, two well-proportioned bedrooms with built-in storage, and a stylish family bathroom.

Additional benefits include elegant wooden flooring, double-glazed windows, and an abundance of natural light, all within a well-maintained period building in a highly sought-after location.

Council Tax: Camden – Band E

Security Deposit: £3,975

Holding Deposit: £795

Deposits shown are based on an Assured Periodic Tenancy Agreement.

-
- 2 Bedrooms
 - Open Plan Kitchen/Reception Room
 - Bathroom
 - Recently Refurbished
 - Wooden Flooring

Council Tax Band: E

EPC: D



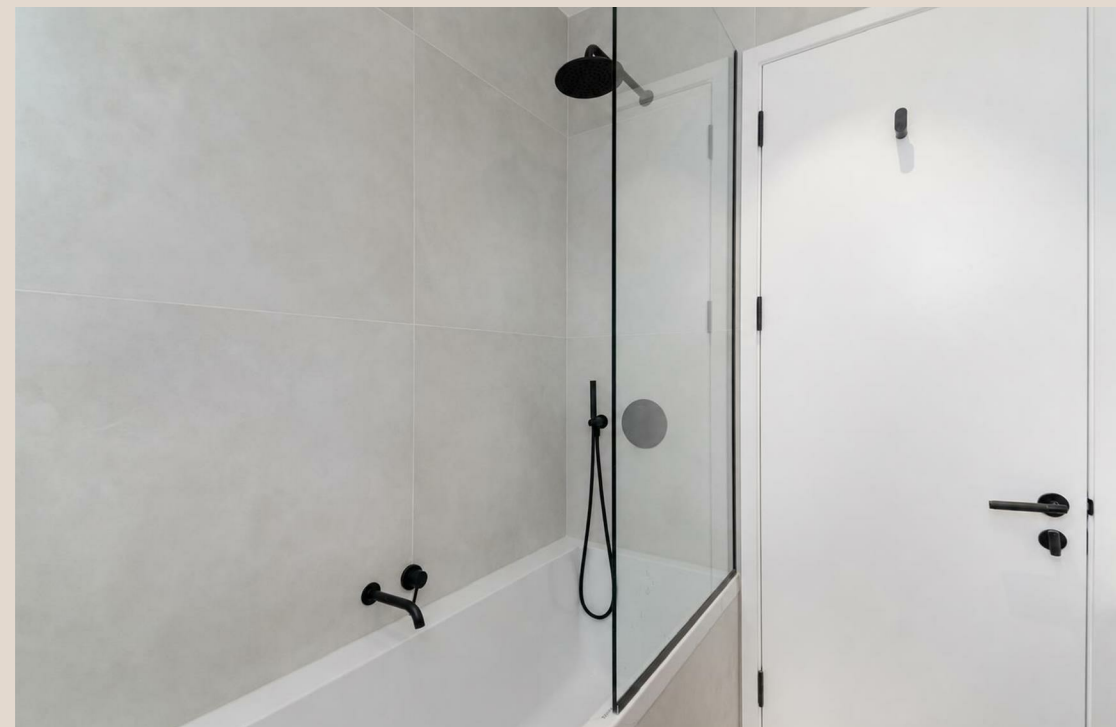



Lindfield Gardens, NW3

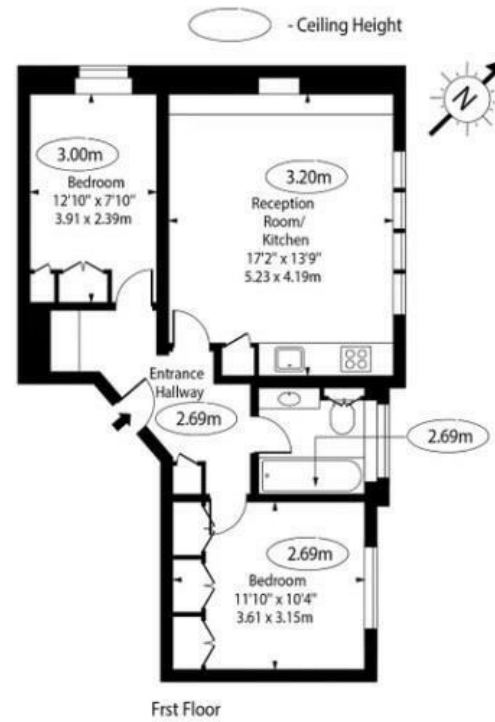

First Floor

Approx Gross Internal Area 600 Sq Ft - 55.74 Sq M

NOT TO SCALE

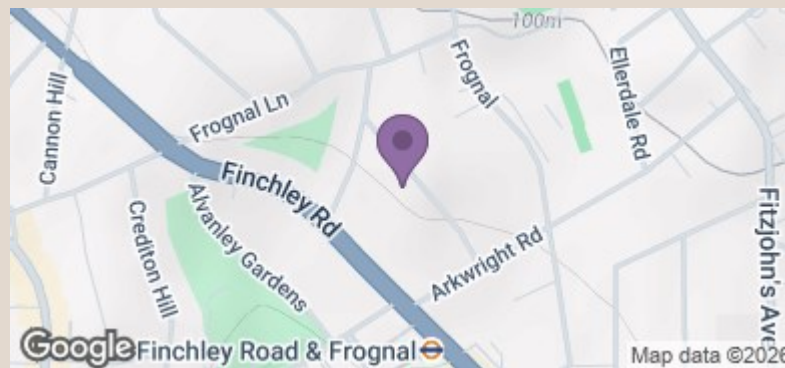

Energy Efficiency Rating		Current	Potential
Very energy efficient - lower running costs			
(92 plus) A			
(81-91) B			
(69-80) C			
(55-68) D		67	
(39-54) E			
(21-38) F			
(1-20) G			
Not energy efficient - higher running costs			
England & Wales		EU Directive 2002/91/EC	